

TECHNICAL SPECIFICATIONS

ABDO NEW RIVER ROOM



BROWARD
CENTER

— *for the* —

PERFORMING ARTS

February 2017

TABLE OF CONTENTS

GENERAL CONTACT INFORMATION.....	2
MAP & DIRECTIONS.....	3
TRUCK, BUS & VEHICLE PARKING	3
SITE PLAN	5
LOADING DOCK INFO	7
SEATING CHART/STAGE DIMENSIONS / GROUND PLAN.....	7
SOUND AND COMMUNICATIONS.....	11
PROJECTION	11
LIGHTING INFORMATION.....	12
ORCHESTRA EQUIPMENT	14
DRESSING ROOM / WARDROBE INFORMATION	15
LOCAL SERVICES (Ground Transportation & Lodging)	16
SHOPPING / OTHER SERVICES.....	21
MEDICAL: HOSPITAL AND DOCTORS	22

Abdo New River Room

at the

Broward Center for the Performing Arts

201 Southwest 5th Avenue

Fort Lauderdale, FL 33312

Main Office (954) 522-5334 (M-F 8:30A-5:30P)

Main Fax 954-468-2549

Box Office 954-468-3338

PRODUCTION STAFF

Director of Production	Tim Lessig	(954) 468-2557	tlessig@browardcenter.org
Production Manager	Chris Jahn	(954) 765-5802	cjahn@browardcenter.org
Production Manager	Lucas Bonewits	(954) 468-3317	lbnewits@browardcenter.org
Production Supervisor	Diane DeChello	(954) 765-5819	ddechello@browardcenter.org
Production Coordinator	Rebecca Feldman	(954) 414-6906	rfeldman@browardcenter.org
Production Coordinator	Katie Byron	(954) 468-3319	kbyron@browardcenter.org
Production Coordinator	Jessica Mendoza	(954) 660-6376	jmendoza@browardcenter.org
Production Coordinator	Jimmy Rodgers	(954) 660-6386	jrogers@browardcenter.org
Production Fax		(954) 468-3315	
Stage Door Security Desk		(954) 468-3323	

EVENT SERVICES STAFF

Vice President of Operations	Shelly Bradshaw	(954) 468-2696	sbradshaw@browardcenter.org
Director of Event Services	Pablo Urquilla	(954) 468-3313	purquilla@browardcenter.org
Event Services Manager	Kerry McCloskey	(954) 414-6905	kmccloskey@browardcenter.org

ADDITIONAL CONTACTS INFORMATION

Vice President of Programming	Matt MacNeil	(954) 468-2551	mmcneil@browardcenter.org
Director Of Programming	Jill Kratish	(954) 468-3295	jkratish@browardcenter.org
Director of Guest Services	David Dillon	(954) 468-3305	ddillon@browardcenter.org
Director of Food & Beverages	Vinnie Venezia	(954) 468-3337	vvenezia@browardcenter.org
Admin. Mgr F&B – Merch	Shari Newberg	(954) 468-3336	snewberg@browardcenter.org
Special Events/Catering Mgr	Kirstie Gothard	(954) 660-6348	kgothard@browardcenter.org
Asst Special Events/Catering	Alex Riccardi	(954) 765-5806	ariccardi@browardcenter.org

MAP & DIRECTIONS

The Broward Center is conveniently located in the Riverwalk Arts & Entertainment District in downtown Fort Lauderdale, equidistant between Dade and Palm Beach Counties and can be reached by several routes.

From Interstate-95:

Exit at Broward Boulevard, Go east.

From Florida Turnpike (southbound):

Exit at Sunrise Boulevard, Go East to South-bound I-95, exit Broward Boulevard, Go east.

From Florida Turnpike (northbound):

Exit at I-595, Go East to North-bound I-95, exit Broward Boulevard, Go east.

To Backstage Parking Lot:

From Broward Boulevard turn right (South) onto SW 7th Avenue (Avenue of the Arts). Turn left at West Las Olas Blvd (the second light). Take an immediate left into the backstage lot security gate. Push the buzzer to contact guard. Identify yourself and guard will let you enter.

To Parking Garage and Valet:

Broward Boulevard. Turn South onto SW 5th Avenue. The Arts and Science Parking Garage is on the immediate right, or, proceed straight ahead, cross 2nd Street (Himmarshee St.) and continue to the top of the hill for valet service.

From Fort Lauderdale Airport to Backstage Lot:

Take the "US1 / Federal Highway Northbound" exit out of the Airport. Travel North on US1 to SE 17th Street Causeway. Turn left (West) and go to SW 4th Avenue and turn right (North). SW 4th Avenue will become SW 7th Avenue at the bridge. Go over the bridge, turn right at West Las Olas Blvd . Take an immediate left into the backstage lot security gate. Push the buzzer to contact guard. Identify yourself and guard will let you enter.

North Gate - Trucks going to Loading Dock:

From Broward Boulevard turn South onto SW 5th Avenue. Turn right at Second Street (Himmarshee Street). The gate entrance to back-stage lot is on your left. Push the buzzer to contact guard. Identify yourself and guard will let you enter.

GPS Address

To the backstage Security gate:
641 West Las Olas Boulevard
Fort Lauderdale

To the North Gate (trucks & buses)
582 SW 2nd Street
Fort Lauderdale FL

VEHICLE PARKING

Parking on site is very limited. Please inquire with Production Staff prior to arrival. There is parking available directly backstage in the lot for 5 cars and additional parking available for 20 cars in the Arts and Science parking garage located across the street from the theatre. All parking arrangements must be discussed with Production Staff prior to the event for necessary passes and badges.

BCPA Parking Lot

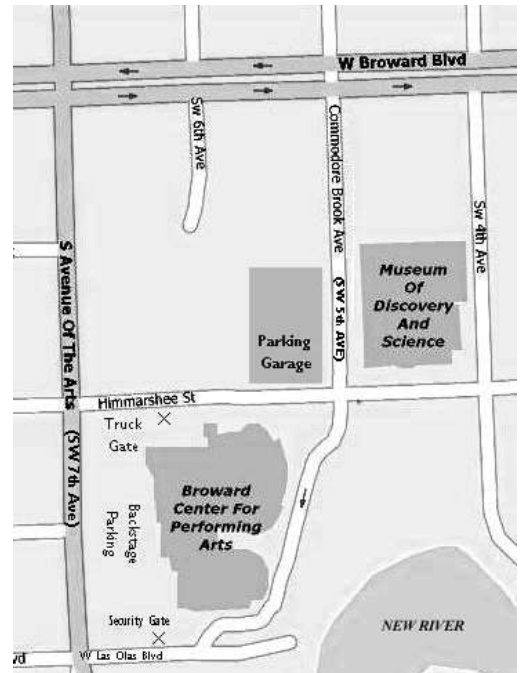



Broward Center Site Plan

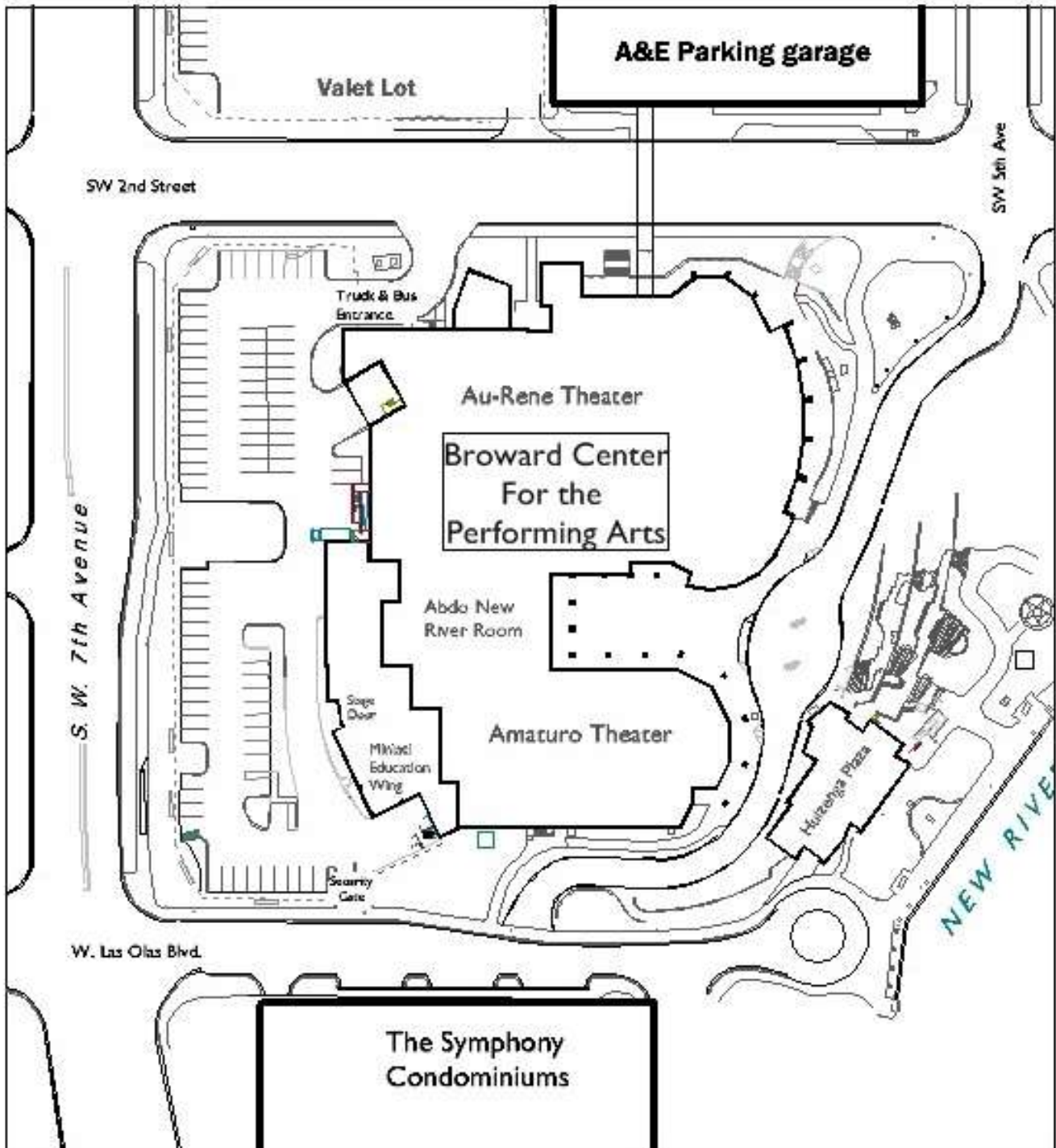

LOADING DOCK

The New River Room does not have a direct loading area. Depending on the installation and the schedule of events, equipment can be brought in from the ramp out in front of the theatre, or the loading dock in the Amaturio Theatre (elevator to the lobby to the south of the room). The elevator doors are 6' wide by 7' high, and the interior space is 8' by 8', with three extra inches added by the indentation of the doors.

The Amaturio Loading Dock is located at the southwest corner of the building at S.W. 7th Ave and Las Olas Boulevard, but trucks must use the entrance on the north end of the parking lot on Himmarshee Street. There are two loading bays. The dock is 3' high, and the receiving doors are 8' wide by 8' high.

DIMENSIONAL INFORMATION AND CAPACITY

The dimensions of the Abdo New River, bare, are 50' deep, by 72' wide, with a ceiling 20' high.

The capacity of the New River Room depends largely on the layout of the room. In the default format setup for a cabaret or dinner theater, the room seats about 144 people. Set up theatre-style, the room can accommodate 200 people.

STAGE SPECIFICATIONS

The "stage" consists of Wenger orchestra risers, and two wood framed profile pieces to create a rounded downstage edge.. The default configuration is 12' deep, 24' wide, and 24" high, with wings consisting of an 8' by 4' riser extending off the upstage edge of each side of the stage. (see a room plots on pages 8 and 9)

RIGGING SPECIFICATIONS

There are seven trusses hung for lighting and sound. There is a decorative wooden grid hung just below the ceiling – it is not weight bearing. There are no additional rigging points available in the New River Room.

HOUSE CURTAIN

There is no house curtain.

SOFT GOODS INVENTORY

There is a limited set of pipe and black drape; enough to create a backstage with wings around the stage, completely obscuring the north wall of the New River Room.

SEATING CHARTS & ROOM LAYOUT

Cabaret Style (default)

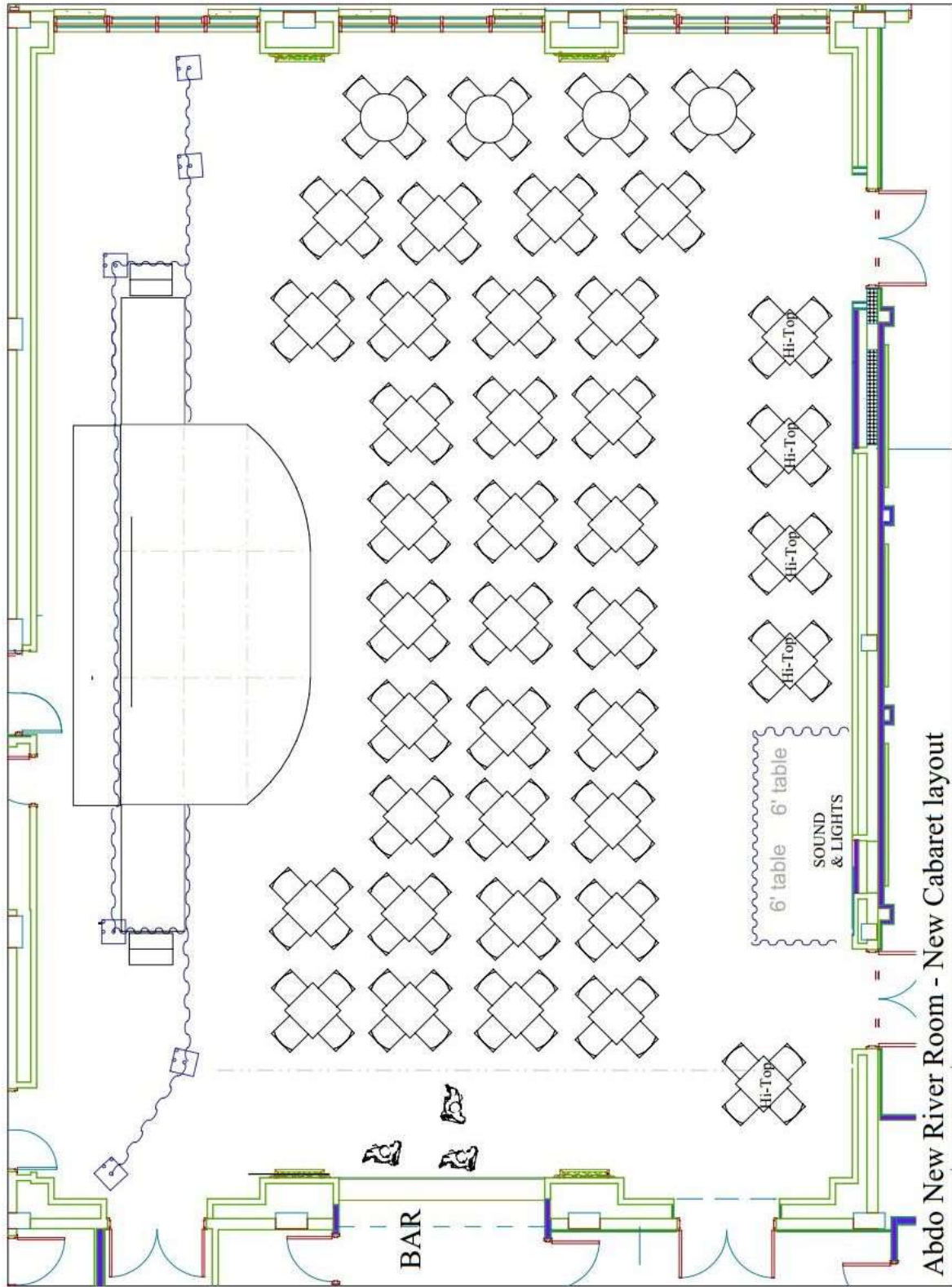

Revised 1/12/16

capacity 160

Abdo New River Room - New Cabaret layout

31 square cafe tables, 4 round cafe tables
5 square hi-tops



Theatre Style

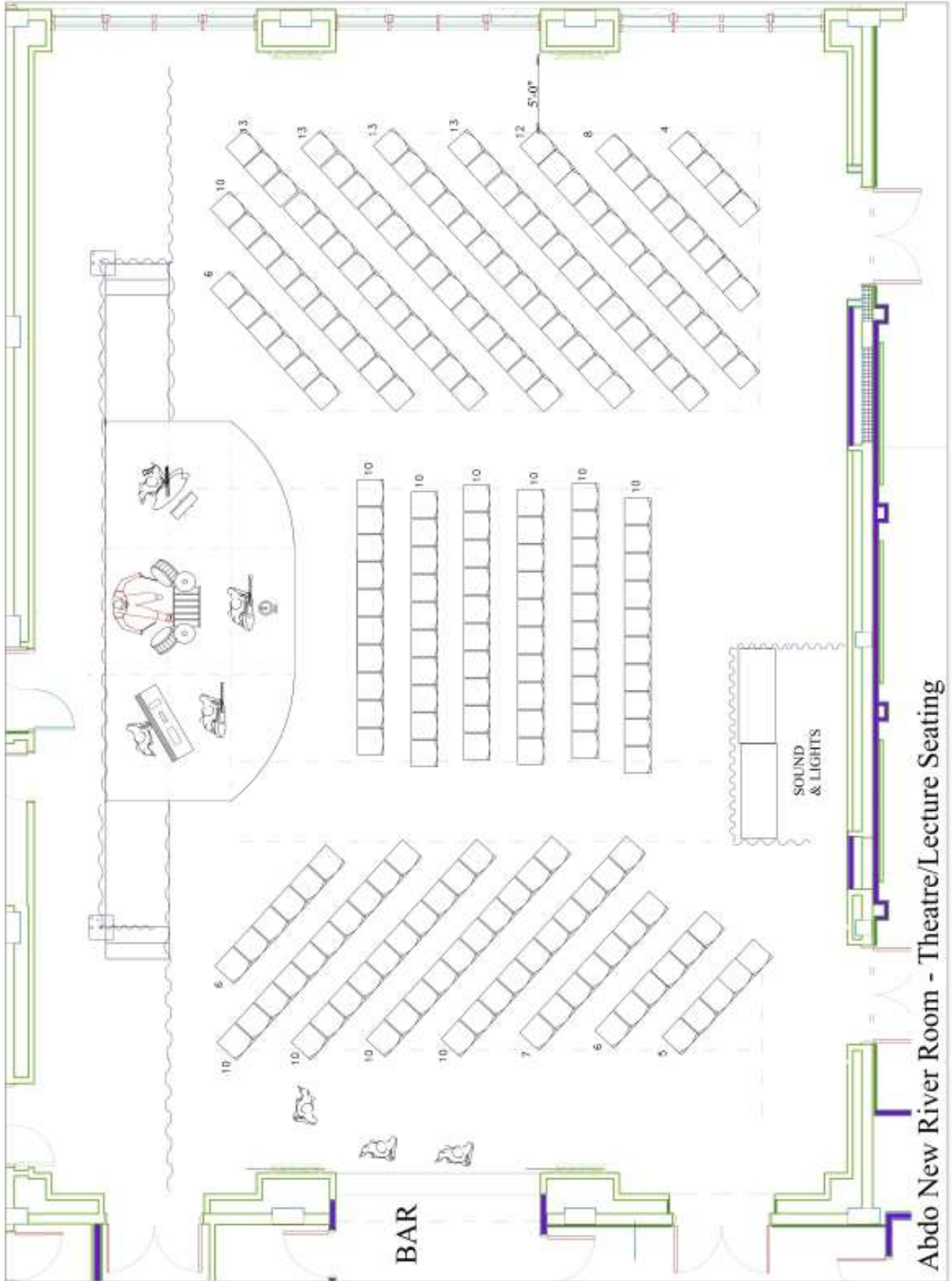

Revised 7/18/14

capacity 216



SOUND AND COMMUNICATIONS

SPEAKER CONFIGURATION

- (4) QSC HPRI22i 12" 2-way powered Loudspeakers hung over stage
- (2) QSC HPRI81i 18" Subwoofers w/wheels

SOUND MIX POSITION –

Primary position is along south wall, towards the west end of the room. A 32 channel snake with 8 channels of return run from that location to backstage.

FRONT OF HOUSE CONSOLE

Yamaha LS 9-32 (32 x 16 x 8)

ADDITIONAL OUTBOARD GEAR

- (1) DBX Driverack 260 2 x 6 Processor

SOURCE PLAYBACK GEAR

- (1) CDRW900SL CD R/RW Recorder w/MP3 Playback
- (1) TASCAM CD-200 CD Player

MONITOR SPEAKERS:

- (2) QSC HPRI22i 12" 2-way powered Loudspeakers

MICROPHONES:

- (2) SHURE SLX2 BETA 87 A MIC (hand held) J3 Range Frequency
- (8) SHURE SLX14 Body Pack System G4 Range Frequency
- (8) SHURE SLX14 Body Pack System J3 Range Frequency

(Note that HH and body packs share receivers (16 total) - you cannot use ALL the body packs AND the wireless handhelds at the same time)

PROJECTION

PROJECTOR

The Abdo New River Room is equipped with a Barco PGXG-61B single DLP projector at 6750 ANSI lumens that projects onto a 9x12 front projection screen that is hung up stage. The projector is permanently mounted to the ceiling.

SOURCES

A laptop can be connected to the projector via VGA from the stage or from the control booth. DVD players or other sources can be connected via a Kramer switcher/scaler. Please make these arrangements in advance, as the switcher and the DVD players are

OPTIONS

There is a split off of the projector feed that runs to the stage so that a confidence monitor can be installed so a speaker can see what is projected behind them.

LIGHTING INFORMATION

The New River Room has a permanent lighting plot that includes front washes, backlights, side fills, and a pattern breakout wash on the walls of the hall.

A LightWright file and an AutoCAD drawing of the lighting plot are available on request.

CONTROL

- 1 ETC Element console, 2 monitors
- 14 ETC Smart Bar SB6 (84 dimmers total)

POWER DISTRIBUTION

There is a 200 amp breakout in the Air Wall Closet (north wall by kitchen). Standard Cam-Lok connectors (Ground and Neutral reversed).

FOLLOWSPOTS

There are no followspots in the Abdo New River Room

COMPLETE INVENTORY

The New River Room has a permanent repertory light plot; all the inventory is hanging.

Unit Description	Detail	Total	Hanging	Storage
ETC Source Four ERS	26 deg 575W	30	30	0
ETC Source Four ERS	36 deg 575W	12	12	0
ETC Source Four PAR		12	12	0
Chauvet Rogue I Spots		12	12	0
Colorado Zoom Tour LED PARS		4	4	0

Stage Lighting Plot

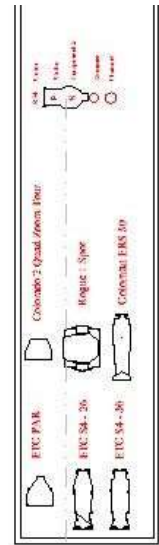
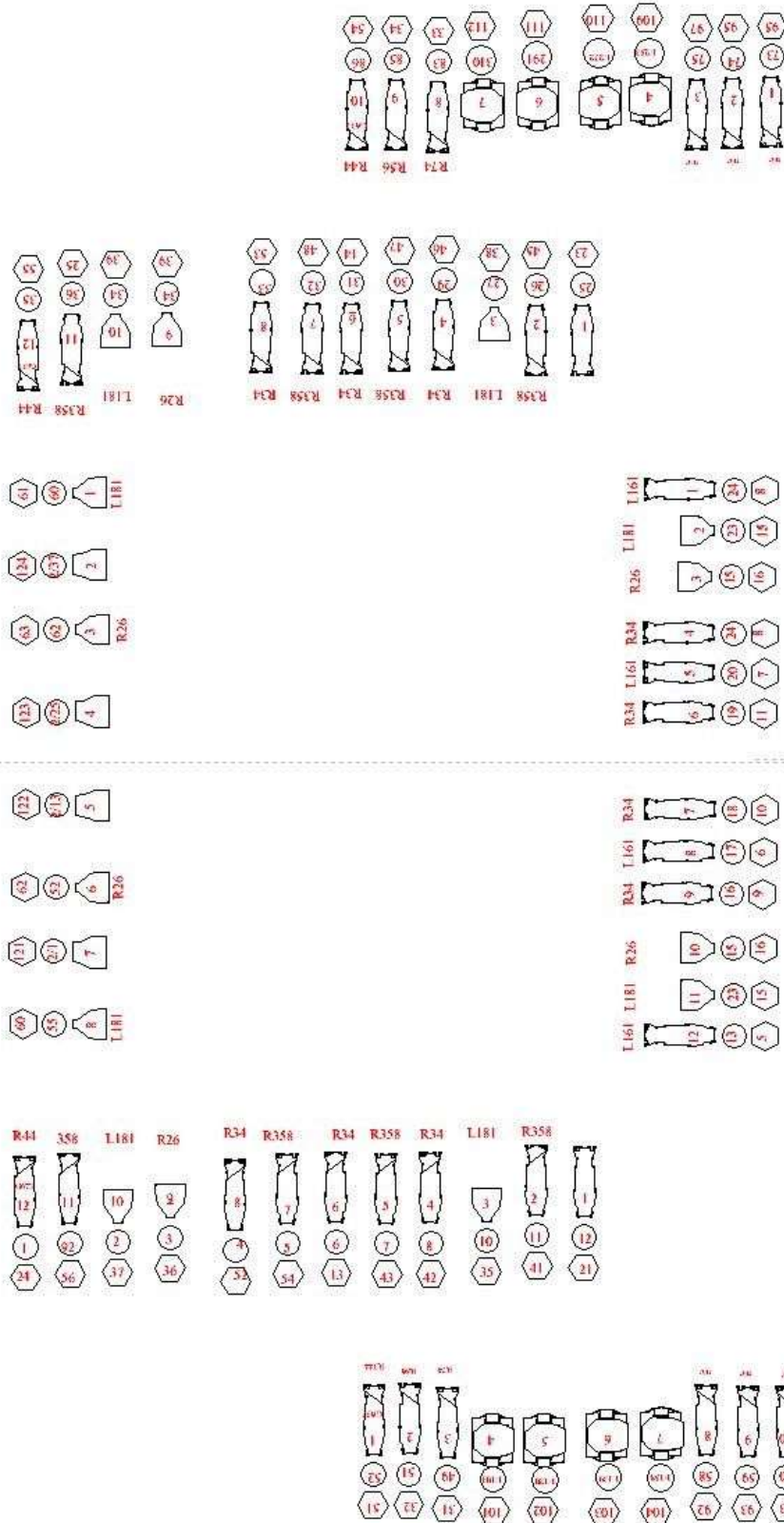

Revised 12/19/16

Abdo New River Room -
Default LX plot
(NO SCALE)

ORCHESTRA EQUIPMENT

This equipment is shared between rooms, and is only available by prior request.

CHAIRS/STANDS

96	Wenger Orchestra Chairs
6	Cello Chairs
87	Music Stands w/lights
1	Conductor's Podium and Stand
10	Stools
10	3'x 6' Tables

RISERS: Black skirting is available for risers

10	4'x 8'x 8"h
10	4'x 8'x 16"h
20	4'x 8'x 24"h

STEP UNITS:

2	8" single step units
2	16" step units
2	24" step units

PIANOS (Note: Pianos tuned only by House Tuner Only)

1	7' Steinway Grand Model B (floor only – can't go on stage)
4	Yamaha Uprights

DRESSING ROOM / WARDROBE / GREEN ROOM INFORMATION

DRESSING ROOMS

There are two dressing rooms behind the stage in the New River Room

Dressing room 1 can accommodate 6 actors

Dressing Room 2 can accommodate 4 actors.

SUPPORT SPACES

The Abdo New River Room is not equipped with office space or green room space.

ADDITIONAL RENTAL SPACES: The following space(s) must be reserved in advance, and are subject to availability.

EINSTEIN ROOM: The Einstein Room is 36' x 18' and is located next to Au-Rene Green Room, one floor directly below the Abdo New River Room. There is no audio or video feed from the New River Room to the Einstein Room.

MAYHUE ROOM: The Mayhue room is a conference room that can seat approximately 12 people. It is located across the lobby from the Abdo New River Room. There is no audio or video feed from the New River Room to the Mayhue Conference Room.

LOCAL SERVICES

GROUND TRANSPORTATION

Checker Taxi
954-923-9999

Yellow Cab
954-777-7777

Broward County Transit
954-357-8400
www.Broward.org/bct

A Personal Touch Limousine Service
800-741-2785
<http://www.aptilimo.net/>

Water Taxi
954-467-6677

Sun Trolley
954-761-3543

Tri-Rail
(800) 874-7254
www.Tri-rail.com

LODGING INFORMATION

The Broward Center for the Performing Arts maintains several official lodging partners. If your organization is seeking housing, please contact the following properties and identify yourself as an artist, crew or patron of the Broward Center. The hotel will give you our special rates if available.

Hampton Inn
250 N. Andrews Ave.
Fort Lauderdale, FL 33301
954.924.2700
hamptoninnftlauderdale.com

Sonesta Fort Lauderdale
999 North Fort Lauderdale Beach Blvd
Fort Lauderdale, FL 33304
954-315-1460
www.sonesta.com/fortlauderdale

W Fort Lauderdale
999 N. Fort Lauderdale Beach Blvd.
Fort Lauderdale, FL 33304
866.616.2572
wfortlauderdalehotel.com

Riverside Hotel
620 E. Las Olas Blvd.
Fort Lauderdale, FL 33301
800.325.3280
riversidehotel.com

BANKING

Sun Trust Bank
601 W. Broward Blvd
Fort Lauderdale, FL 33312
954-713-1492

Bank of America
401 East Las Olas Blvd
Fort Lauderdale, FL 33301
954-524-6581

Wells Fargo
1 East Broward Blvd
Fort Lauderdale, FL 33301
954-762-9200

COPIES/PRINTING

FedEx Office
300 North Federal Highway
Fort Lauderdale, FL 33301
954-467-1007

Reprograffia (Blueprints)
801 N. Andrews Ave
Fort Lauderdale FL 33301
954-525-0157

DELIVERY SERVICES

US Post Office
400 NW 7th Ave
Ft. Lauderdale, FL 33311
(800) ASK-USPS
954-523-0327

The Broward Center has regularly
scheduled daily delivery/pick up from UPS,
FedEx and USPS

ENTERTAINMENT / ATTRACTIONS

Ft. Lauderdale has many choices for entertainment all year around from beaches to museums and everything in-between. Here are just a few choices.

AutoNation IMAX Theatre
(at the Museum of Discovery & Science)
401 S.W. 2nd Street
Fort Lauderdale, FL 33312
954-467-6637

Greater Ft. Lauderdale Convention &
Visitors Bureau
954-765-4466
www.sunny.org

Museum of Art Fort Lauderdale
One East Las Olas Blvd.
Fort Lauderdale, FL 33301
954-525-5500

Billie Swamp Safari
(Everglades Tours, Airboat rides, Swamp
Buggy rides)
800-GO-SAFARI
www.billieswamp.com/

Seminole Hard Rock Hotel & Casino
1 Seminole Way
Hollywood, Florida 33314
954-327-7625

DINING / NIGHTLIFE

Please check out the “Go Riverwalk” and “Riverwalk A & E” websites below for more information on restaurants and nightlife surrounding the Broward Center.

<http://www.goriverwalk.com/>

<http://www.riverwalkartsandentertainment.com/>

The Production Department has menu books available which includes local restaurant menus, many with take-out and delivery available. There are many restaurants, bars and clubs within walking distance of the Broward Center. Here are just a few choices.

The Chimney House

701 W Las Olas Blvd

Fort Lauderdale, FL 33312

954-900-5352

www.thechimneyhouse.net

Walking Distance: .01 mile (next to BCPA)

Himmarshee Public House

201 SW 2nd Street

Fort Lauderdale, FL 33301

954-616-5275

<http://publichouseftl.com/>

Walking Distance: .02 mile

YOLO

333 E Las Olas Blvd

Fort Lauderdale, FL

954-523-1000)

www.yolorestaurant.com

Walking Distance: 1.1 mile

Tarpon Bend (restaurant & bar)

200 SW 2nd Street

Fort Lauderdale, FL 33301

954-523-3233

www.tarponbend.com

Walking Distance: .04 mile

Grille 401

401 E Las Olas Blvd

Fort Lauderdale, FL 33301

954-767-0222

www.grille401.com

Walking Distance: Less than 1 mile

The Royal Pig Pub

350 East Las Olas Boulevard

Fort Lauderdale, FL 33301

954-617-7447

<http://www.royalpigpub.com/>

Walking Distance: 1.2 Miles

15th Street Fisheries

1900 SE 15th Street

Fort Lauderdale, FL 33316

954-763-2777

www.15streetfisheries.com

Walking Distance: 2.77 miles

Bimini Boatyard

1555 SE 17th Street

Fort Lauderdale, FL 33316

954-525-7400

www.biminiboatyard.com

Walking Distance: 3.01 miles

Café Vico

1125 N. Federal Highway

Fort Lauderdale, FL 33304

954-565-9681

www.cafevicorestaurant.com

Distance: 3.1 miles

FLORISTS

Ann's Florist & Greenhouse
1001 E Las Olas Blvd
Fort Lauderdale, FL
954-761-3334

A Basket Affair
830 E. Oakland Park Blvd, Suite 101
Oakland Park, FL 33334
954-567-2052

GYM

Bally Total Fitness
750 W Sunrise Blvd
Fort Lauderdale, FL 33312
954-764-8666

The Firm Fitness Center
928 N Federal Hwy
Fort Lauderdale, FL 33304
954-767-6277

The Fitness Company
110 SE 6th St – 7th Floor
Contact Rhonda 954-761-1110
FAX 954-463-4952

LA Fitness
3825 N. Federal Hwy.
Contact: Matt 954-567-2727
Day Passes \$15.00

HAIR

Las Olas Barber Shop
1400 E. Las Olas Blvd.
Ft. Lauderdale, FL 33301
Open 7 days a week, will come to theatre
954-462-1351

Source Spa & Salon
1881 NE 26th Street, Suite 30
Wilton Manors, Florida 33305
954-568-1998

HARDWARE/SUPPLIES

Home Depot
1000 NE 4th Street
Fort Lauderdale, FL 33304

McDonald's Hardware
245 SW 24 Street
Fort Lauderdale, FL 33315
954-463-2000

Miami Stagecraft (sales & rentals)
2855 East 11th Ave
Hialeah, FL 33013
305-836-9356

Stage Equipment and Lighting, Inc.
12250 NE 13th Court
Miami, FL 33161
(305) 891-2010

LAUNDRY / DRY CLEANING

Dry Cleaning Depot
730 W. Broward Blvd
954-522-1126

Fashion Cleaners
2427 W. Broward Blvd
954-583-8225

SHOPPING

Publix (Grocery and Pharmacy)

601 South Andrews Avenue
Fort Lauderdale, FL 33301
954-728-8330
(7:00am – 11:00pm)

Whole Foods Market

2000 N Federal Hwy
Fort Lauderdale, Florida 33305
954-565-5655
Mon - Sun: 8am - 10pm

Walgreen's Pharmacy

700 Broward Blvd
Fort Lauderdale 33301
954-463-9937
(7:00am- 11:00pm)

Galleria Mall

2414 East Sunrise Blvd
Fort Lauderdale, Florida 33304
Phone: 954-564-1015

The Fresh Market

424 N Federal Hwy, Fort Lauderdale, FL
33301
954-763-1250
Mon - Sun: 8am - 10pm

CVS/Pharmacy

1 North Federal Highway
Fort Lauderdale, FL 33301
954-524-0500

7-11

460 W Broward Blvd,
Fort Lauderdale, FL
954-467-3856
(24 Hour)

Sawgrass Mills Mall (Outlet Mall)

12801 West Sunrise Blvd
Sunrise, FL 33323
954-846-2350

MASSAGE (will come to theater or housing)

James Perc
(Swedish and Deep Tissue massage; Hot Stone)
Lic # MA43130
954-534-6611
bodyworkbyjim@yahoo.com

Lawrence Zwarich
(Swedish and Deep Tissue massage)
Lic # MA43125
954-383-8891
cdnlar@hotmail.com

Diva's Day Spa
Full-service Spa located next door to the
Broward Center in the Symphony building.
Will come to the theater for massages.
954-522-1141 x 6 or 954-771-9772
(ask for Jacki and let her know you are a performer
at the Broward Center for a discount on services)

MEDICAL

Hospitals and clinics are listed first, followed by Doctors (listed alphabetically by specialty)

HOSPITALS

Broward General
1600 South Andrews Avenue
Fort Lauderdale FL 33304
954-355-4400

Imperial Point Medical Center
6401 North Federal Highway
Fort Lauderdale, FL 33308
954-776-8500

URGENT CARE

Broward Health Urgent Care
200 Northwest 7th Avenue
Fort Lauderdale, FL 33311
954-759-6794

Concentra Urgent Care Center
1347 S. Andrews Avenue
Fort Lauderdale, FL 33304
954-767-9999

Health Med Centers (Cash/Credit Only)
1493 SE 17th Street
Fort Lauderdale, FL 33316
954-525-7595

CHIROPRACTIC

Downtown Chiropractic Center
1601 E. Broward Blvd.
Ft. Lauderdale, FL
954-463-1166

Marcus Chiropractic Center
Dr. Peter Marcus
2710 E. Oakland Park Blvd, FT L 33306
954-566-3027 (Will make House Calls)

Dr. Patrick Helmer - Chiropractor
9532 Griffin Rd. Suite 1800
Cooper City, FL 33328
954-434-1800

DENTAL

Dr. Ari Arocha
113 SW 11th Ct
Ft Lauderdale, FL 33315
(954) 463-7972

Dr. Thomas Jeson
3000 E. Commercial Blvd.
Ft. Lauderdale, FL 33308
954-491-1904
Fax – 954-772-3453

Dr. Larry Levinson
9 SW 17th St.
Ft. Lauderdale, FL 33315
954-524-3117

Dr. Jeffrey Bartlett
2440 E. Sunrise
In the Galleria Mall
954-566-8668

DERMATOLOGY

Dr. Babinski
1102 E. Broward Blvd.
Fort Lauderdale, FL 33312
954-463-5406
*Will make emergency theatre calls

Dr. Smith / Las Olas Dermatology
800 E. Broward Blvd. Suite 507
Ft. Lauderdale, FL 33301
954-763-4331

EAR / NOSE/ THROAT

Dr. Herbert Moselle, ENT
201 NW 82nd Ave.
Plantation, FL 33324
954-472-1212

Dr. Bruce Weissman* - ENT, Voice Care
2100 Hallandale Beach Blvd Suite 405
Hallandale, FL 33009
o: 954-454-0544 cell: (305) 505-0666;

EYE CARE

Dr. Goldberg and Dr. Nolan
Eye Physician & Surgeon
2334 NE 53rd Street
Ft. Lauderdale, FL 33308
(954)776-2020

FAMILY/GENERAL PRACTICE

Dr. Ed Grenet - Health-Med Centers
1493 SE 17th Street
Ft. Lauderdale, FL 33316
954-525-7595 fax# 954-525-7599

Dr. Harvey Kleiner, DO
8890 W Oakland Park Blvd, Suite 100
Fort Lauderdale, FL 33351
954-741-3304

Dr. Myron Davidson
2500 NE 15th Ave
Wilton Manors, FL
954-533-5382

Dr. Glenn Moran, DO
Plantation Family Medical Assocs
201 Northwest 82nd Avenue Suite 401
Plantation, FL 33324
954-472-5100

OB/GYN

Dr. Amy Sonnenblick
954-635-6243

Dr. Trudi Fahey at Broward Medical Center
954-467-2013

All Women's Health
954-452- 5850

Dr. Amy Sonnenblick
954-635-6243

ORTHOPEDICS

Dr. Bruce Fletcher
Northwest Broward Orthopedic Associates
5901 Colonial Dr, Suite 201
Pompano Beach, FL 33063
954-979-3255

YOGA

Mandala Yoga Center
2449 NE 13th Ave.
Wilton Manors, FL 33305
973-573-2663
Mandalayogacenter.com